

# Technical data sheet

## MINIFLUX Sanitary



More than just pumps

### MINIFLUX Sanitary



**MADE IN GERMANY**



#### Advantages/characteristics:

- ▶ To transfer out of IBCs and other containers with outlet connection at the bottom
- ▶ Particularly suitable for hygiene applications
- ▶ For horizontal use / dry installation outside the container - medium only comes into contact with the inside of the pump.
- ▶ Designed with minimal dead space and easy to clean
- ▶ No greased seals - no risk of grease being carried over into the medium
- ▶ Can be disassembled without tools
- ▶ Emptying IBCs with residual quantity of less than 1 % (depending on the inclination angle)
- ▶ Can be combined with commutator motors, brushless motors and air motors
- ▶ Suitable for continuous operation, dry running to a limited extent
- ▶ Version with ETFE rotor FDA CFR 21 compliant
- ▶ Version with stainless steel rotor



#### Dismantled for cleaning in 20 seconds

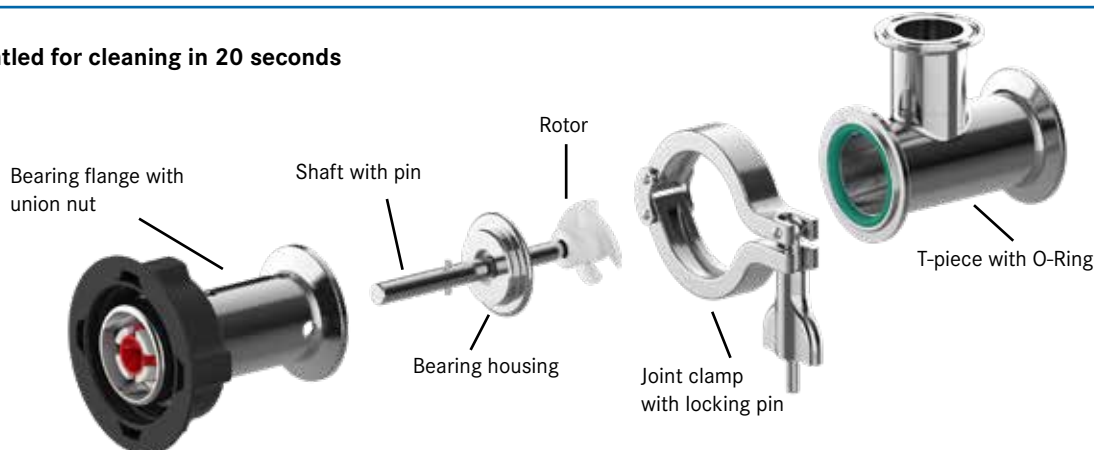

Performance data	
Delivery rate max.	240 l/min *
Viscosity max.	1.000 mPas *
Delivery head max.	13 mWs *
Connection	
Inlet connection	Clamp 2" (or S60x6 adapter)
Discharge connection	Clamp 1 1/2"
Materials	
Outer tube	Stainless steel (316 Ti)
Lip seal	PTFE
Seals	FKM / EPDM
Rotor	ETFE
General data	
Total length	199,5 mm
Weight	1,8 kg
Media/ambient temperature max.	max. 100°C

\* depending on motor and medium, measured at free outlet

#### Performance chart

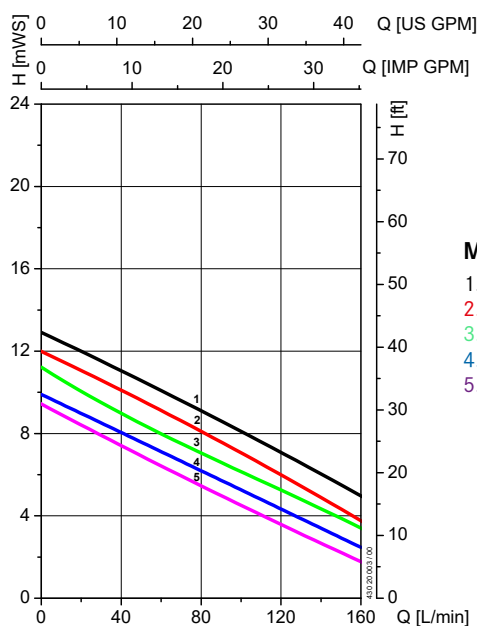

#### Motor:

1. F 416 Ex
2. F 457/F 458-1/F 460-1 Ex
3. FBM 4000 Ex
4. FEM 4070
5. F 458/F 460 Ex

measured at free outlet, water 20 °C, values ± 10 %

# Technical data sheet

## MINIFLUX Sanitary



More than just pumps

Rotor	Seal	Part number pump	Part number Pump incl. adapter with S60x6 connection, seal and hinged clamp
Compliant with EC 1935 / 2004			
Stainless steel	FKM	10-430 20 008	10-430 20 012
Stainless steel	EPDM	10-430 28 003	10-430 28 004
Compliant with FDA CFR 21			
ETFE	FKM	10-430 20 006	10-430 20 007
ETFE	EPDM	10-430 28 001	10-430 28 002



Dimensional drawing [mm]

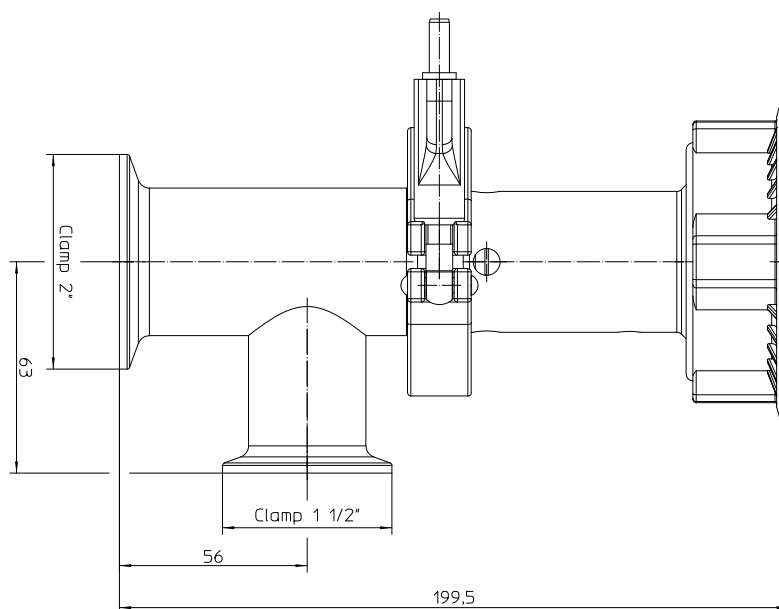

**FLUX-GERÄTE GMBH**  
Talweg 12 · D-75433 Maulbronn  
Tel +49 (0)7043 101-0 · Fax +49 (0)7043 101-555  
info@flux-pumpen.de · www.flux-pumpen.de